



Standard White Finish with Stockton Lites

RPI 261 Insulated Steel Model

Arm-R-Lite's RPI 261 Model features 2" thick insulated sandwich panels constructed from top quality materials, highly detailed raised panel embossment, deep woodgrain texture and two coat prefinished paint system all combine to enhance the beauty of your home.

- Insulated with R-Value of 10.25
- Window Leded Lites Available
- Raised Panel Design

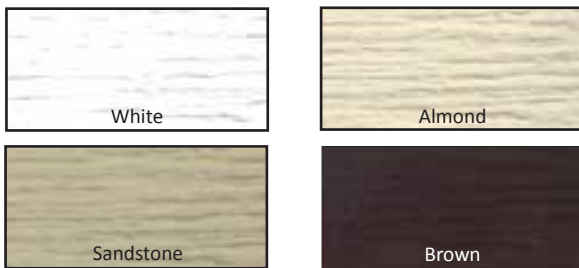

Printed color is subject to distortion.

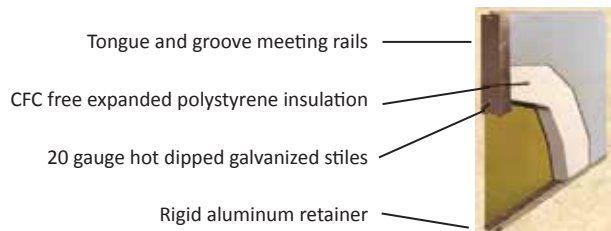

RPI092017V1

