

RPI 261

RESIDENTIAL STEEL COLLECTION

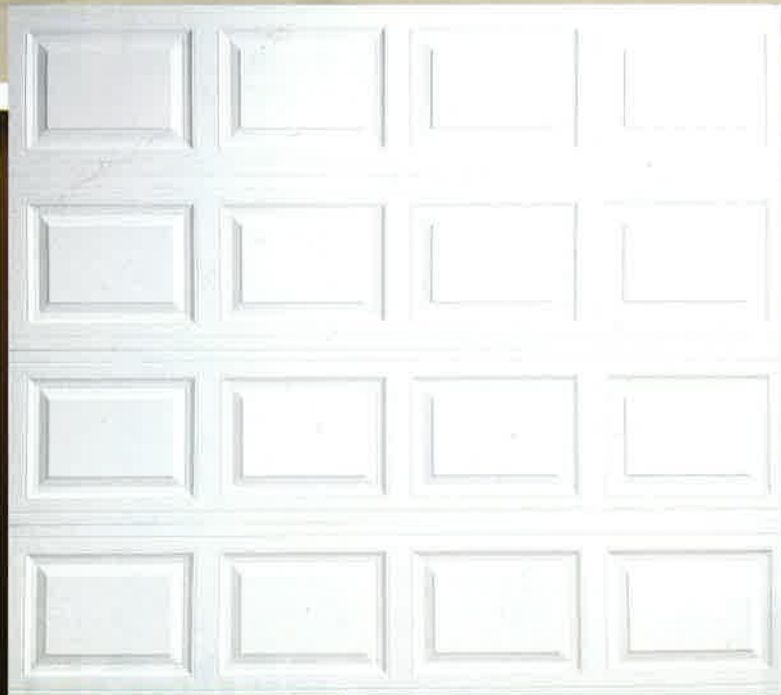

Traditional Raised Panel Insulated Sandwich Residential Garage Door

2" thick insulated sandwich panel constructed of top quality materials, highly detailed raised panel embossment, deep woodgrain texture and two coat prefinished paint system all combine to enhance the beauty of your home.

RPI 261 Insulated - R value: 10.25



ARM-R-LITE

DOOR MANUFACTURING CO., INC.
Phone: (908) 754-2600 • Fax: (908) 754-6522
www.arm-r-lite.com • 800-554-5816

RPI 261 RESIDENTIAL STEEL COLLECTION

Features:

- **Sandwich type construction** with CFC free expanded polystyrene insulation pressure bonded between two sheets of 26 gauge hot dipped galvanized steel with a 10.25 R value.
- **1.0 mil paint system** includes .25 mil rust inhibiting primer and .75 mil exterior top coat that resists fading and chalking while providing consistent color from panel to panel.
- **20 gauge** hot dipped galvanized steel hinge plates run the full height of each section at all hinge locations to facilitate the attachment of hinges, handles, struts and step plates.
- **Rigid aluminum retainer** provides added strength while securing replaceable U-shaped bottom weatherstrip.
- Sections include **tongue and groove** meeting rails for superior strength and better sealing against wind, rain and snow.

#306 Sherwood



#305 Williamsburg



#591 Cascade



#393 Cathedral



#397 Stockton



#320 Waterton



Cut-away view:

- Tongue and groove meeting rails.
- CFC free expanded polystyrene insulation.
- 20 gauge hot dipped galvanized steel hinge plates.
- Rigid aluminum retainer

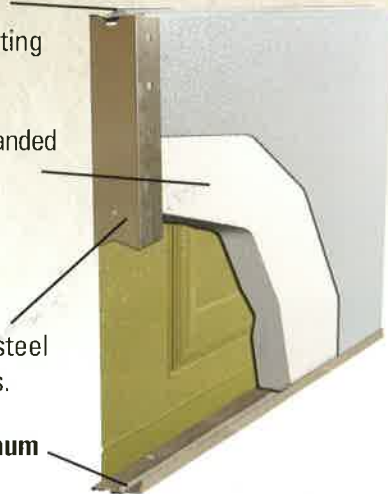

Also Available:

LEADED LITES



Authorized Dealer:

Colors Available:



Brochure color may vary from actual product.



ARM-R-LITE
DOOR MANUFACTURING CO., INC.